



LEGEND	
FINISHES AS PERMITTED	
	(1) BLANCO SERENA GRANITE (Granite Honed Finish) At ground to first floor level and ground floor colonnade
	(2) CREAM FATIMA LIMESTONE (Limestone Honed Finish) At bays to upper levels, above first floor
	(3) KARELIA RED GRANITE (Granite Honed Finish) At bays to upper levels
	(4) THROUGH COLOUR RENDER FINISH GREY OR SIMILAR APPROVED To Penthouse Levels
	(5) THROUGH COLOUR RENDER FINISH BEIGE OR SIMILAR APPROVED Internal Courtyard - Upper floor levels
	(6) THROUGH COLOUR RENDER FINISH RED OR SIMILAR APPROVED Internal Courtyard - Upper floor levels

NOTE: COLOURS ARE INDICATIVE ONLY.

#### CHANGES FROM SCHEME PERMITTED UNDER ABP-307415-20:

- (1) ALL PERMITTED BEDROOM DOORS  
OPENING ON TO BALCONIES  
CHANGED TO WINDOWS TO IMPROVE  
SAFETY AND SECURITY.
- (2) PERMITTED GLAZED ATRIUM AT ROOF  
LEVEL (ABOVE STAIR AND LIFT CORE)  
REMOVED FOR FSC PURPOSES
- (3) GLAZED LINK CORRIDORS BETWEEN  
BUILDINGS REMOVED
- (4) WINDOWS TO WC SHOWER AREA  
OMITTED FOR PRIVACY
- (5) MINOR CHANGES TO FENESTRATION  
TO ACCOMMODATE IMPROVED  
APARTMENT LAYOUTS
- (6) NON-STRUCTURAL COLUMNS  
OMITTED FROM BALCONIES TO  
IMPROVE DAYLIGHT INTO  
APARTMENTS

NOTE: TREES SHOWN AS INDICATIVE ONLY,  
REFER TO THE ARBORISTS REPORTS, TREE  
PROTECTION PLANS AND LANDSCAPE  
MASTERPLAN FOR DETAILS ON ALL TREES



#### LISIEUX PARK

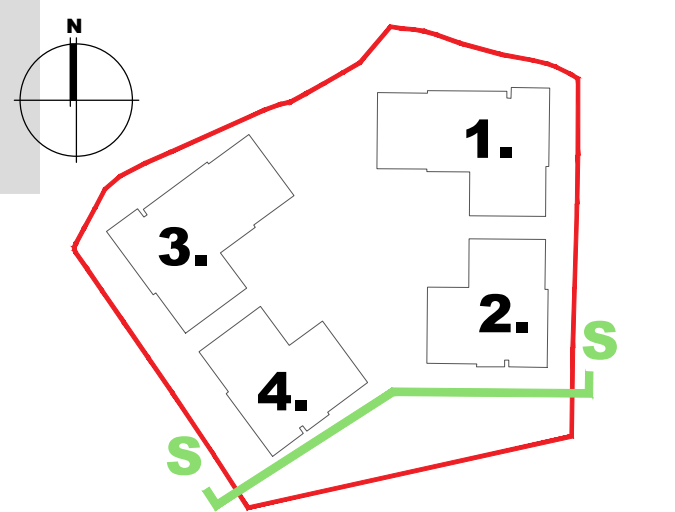

#### South Elevations Permitted & Proposed

<b>Notes</b> 1. Copyright Reserved 2. Work to figured dimensions only. Do not scale drawing. 3. The contractor is responsible for checking all levels and dimensions on site and shall refer all discrepancies to the Architect. 4. Where appropriate, for details of r.c. structure, or mechanical and electrical details, see Engineers drawings. 5. Proprietary items shall be fixed in strict accordance with manufacturers instructions. 6. Sizes of proprietary items shall be checked with manufacturer. 7. The contractor shall be responsible for the coordination of structure, finishes and services.		<b>Issue Status</b> Progress Planning Application Fire Cert Disability Cert Tender Construction As Built Information Only		<b>No.</b> <b>Date</b> <b>Revision</b> P01 06.10.2023 Planning Permission Application - General Amendments		<b>Initials</b> MC
<b>Project</b> RESIDENTIAL APARTMENTS, LISIEUX PARK Murphystown Road, Leopardstown, Dublin 18		<b>Drawing Title</b> South Elevations - Permitted and Proposed		<b>Scale</b> 1:200@A1		<b>Date</b> 23.05.2022
<b>Stage</b> Planning		<b>Drawn</b> SR		<b>FF</b> FF		<b>Rev</b> P01
<b>Project Code</b> 6275		<b>Job</b> LIS	<b>Origin</b> BKD	<b>Zone</b> ZZ	<b>Level</b> DR	<b>Sheet no.</b> A- 2003

6-7 HARDCOURT TERRACE, DUBLIN 2, IRELAND  
T: +353-1-618 2100 F: +353-1-676 7385  
e: architecture@bkd.ie  
www.bkd.ie

**bkd**architects  
BURKE-KENNEDY DOYLE